



# John Deere - Ersatzteilkatalog

Druckerfreundliche Seite

[Fenster schließen](#)

Katalog: 4143 | Raster: 1F4 | Gruppe: 30 | Seite: 42

Katalogname: 1830, 2030, 2130 Traktoren

Seitenname: KRAFTSTOFF-EINSPRITZPUMPE"ROTO-DIESEL"

Fahrtrichtung: 

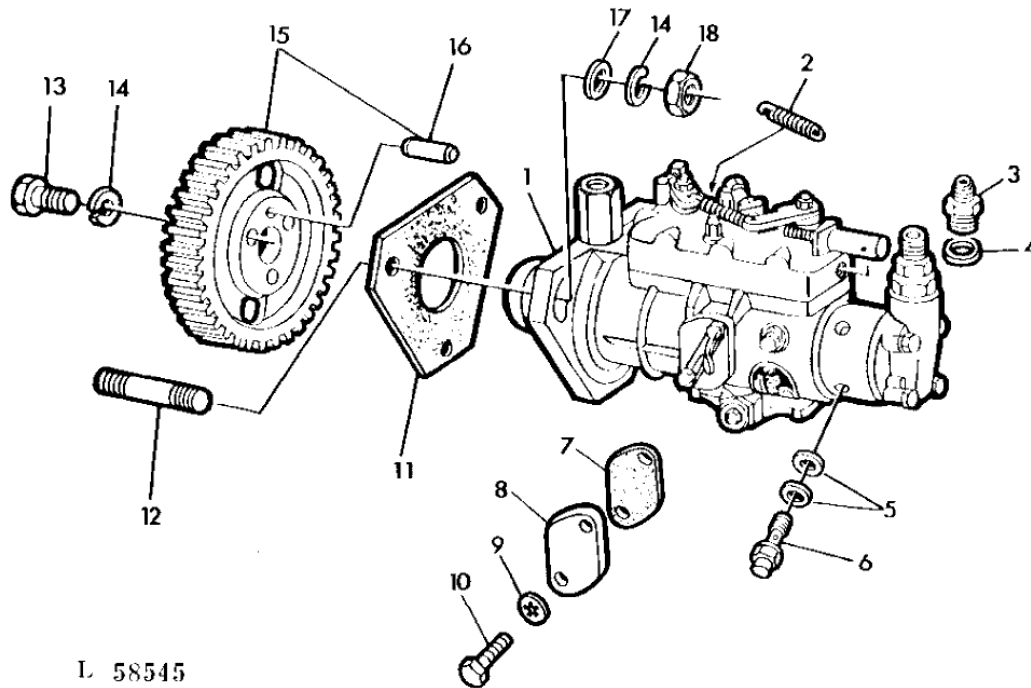

| TEIL | STCK.<br>NR. | BEZEICHNUNG    | STCK | MOTOR<br>SERIEN-<br>NR. | 1830 | 2030 | 2130 | BEMERKUNGEN   |
|------|--------------|----------------|------|-------------------------|------|------|------|---|
| 1    | AR61354      | EINSPRITZPUMPE | 1    | -189967                 | X    | X    |      | ASSY,INCL KEYS 2-10 (ORD AR91774) (ORD W/ AR72879)          |
|      | AR62131      | EINSPRITZPUMPE | 1    | -195852                 | X    | X    |      | (A) ASSY,INCL KEYS 2-10 (ORD AR91773) (ORD W/ AR72879)      |
|      | AR91774      | EINSPRITZPUMPE | 1    | 189968-                 | X    | X    |      | ASSY,INCL KEYS 2-10 ROTO DIESEL R3443F640 (SUB FOR AR72869) |
|      | AR91773      | EINSPRITZPUMPE | 1    | 195853-                 | X    | X    |      | (A) ASSY,INCL KEYS 2-10 ROTO DIESEL-R3443F630               |

|      | AR61397   | KRAFTSTOFFOERDERPUMPE | 1    | -194141          |      |      | X    | ASSY,INCL KEYS 2-10 (ORD AR86016) (ORD W/ AR72879)              |
|------|-----------|-----------------------|------|------------------|------|------|------|---|
|      | AR61354   | EINSPRITZPUMPE        | 1    | -189967          |      |      | X    | (A) ASSY,INCL KEYS2-10 (ORD AR91774) (ORD W/ AR72879)           |
|      | AR91774   | EINSPRITZPUMPE        | 1    | 189968-          |      |      | X    | (A) ASSY,INCL KEYS 2-10 ROTO DIESEL R3443F640 (SUB FOR AR72869) |
|      | AR86016   | EINSPRITZPUMPE        | 1    | 194142-          |      |      | X    | ASSY,INCL KEYS 2-10 ROTO DIESEL-R3443F570                       |
| 2    | T26058    | FEDER                 | 1    |                  | X    | X    | X    |   |
| 3    | R79015    | FITTING               | 1    |                  | X    | X    | X    | (SUB FOR T24607)  |
| TEIL | STCK. NR. | BEZEICHNUNG           | STCK | MOTOR SERIEN-NR. | 1830 | 2030 | 2130 | BEMERKUNGEN   |
| 4    | T24608    | UNTERLEGSCHIEBE       | 1    |                  | X    | X    | X    | OD=16MM(0.62") (FOR T24607)                                     |
|      | T24619    | UNTERLEGSCHIEBE       | 1    |                  | X    | X    | X    | OD=23MM(0.90") (FOR R79015)                                     |
| 5    | T20055    | UNTERLEGSCHIEBE       | 8    |                  | X    | X    | X    |   |
| 6    | AT29464   | VENTIL                | 4    |                  | X    | X    | X    |   |
| 7    |           |                       | 1    |                  | X    | X    | X    | NSEP  |
| 8    |           |                       | 1    |                  | X    | X    | X    | NSEP  |
| 9    |           |                       | 2    |                  | X    | X    | X    | NSEP  |
| 10   |           |                       | 2    |                  | X    | X    | X    | NSEP  |
| 11   | R97354    | DICHTUNG              | 1    |                  | X    | X    | X    | (SUB FOR T24460)  |
| 12   | T23442    | STIFTSCHRAUBE         | 3    |                  | X    | X    | X    |   |
| TEIL | STCK. NR. | BEZEICHNUNG           | STCK | MOTOR SERIEN-NR. | 1830 | 2030 | 2130 | BEMERKUNGEN   |
| 13   | 19H2551   | SECHSKANTSCHRAUBE     | 3    |                  | X    | X    | X    | 5/16"X3/4"  |
| 14   | 12H303    | FEDERRING             | 6    |                  | X    | X    | X    | 5/16"   |
| 15   | AR85710   | ZAHNRAD               | 1    |                  | X    | X    | X    | ASSY,INCL KEY 16, Z=48 (SUB FOR AT27917)                        |
| 16   | T28030    | PASSSTIFT             | 1    |                  | X    | X    | X    |   |
| 17   | 24H1243   | UNTERLEGSCHIEBE       | 3    |                  | X    | X    | X    | 11/32"X5/8"X.060"   |
| 18   | 14H785    | MUTTER                | 3    |                  | X    | X    | X    | 5/16"   |

(A) FOR HIGH ALTITUDE OPERATION  
 POUR UTILISATION A HAUTE ALTITUDE  
 FUER HOCHGELEGENE EINSATZGEBIETE  
 PER LAVORI AD ALTEZZE ELEVATE

PARA LA OPERACION EN ZONAS MUY ELEVADAS  
FOR ARBETE PA HOGA HOJDER